

Steel Pontoon

Assembly of T- and L-Pontoon.

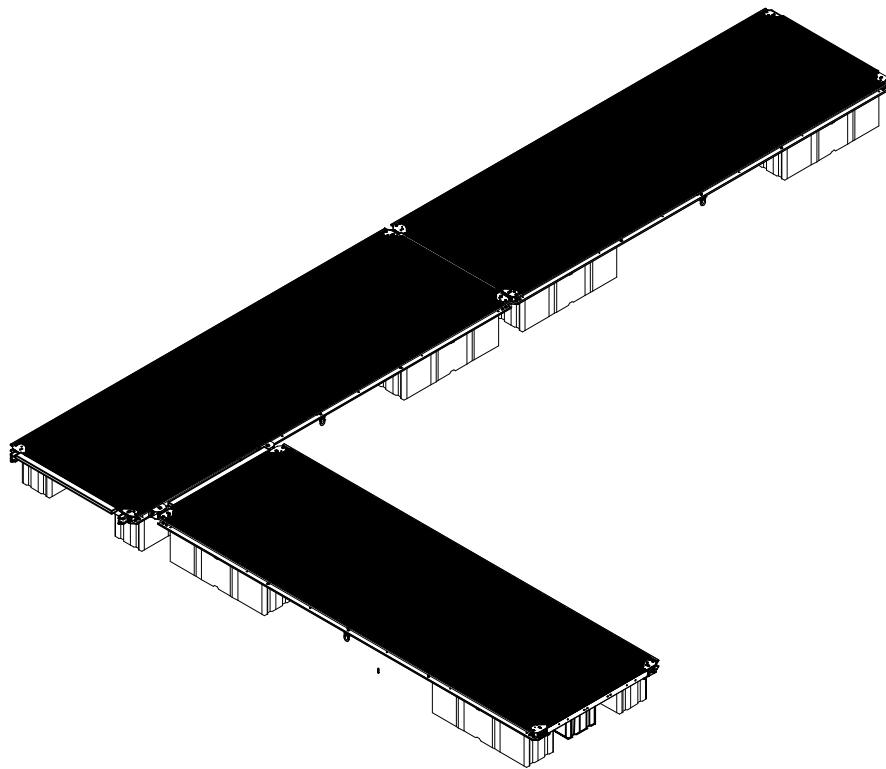

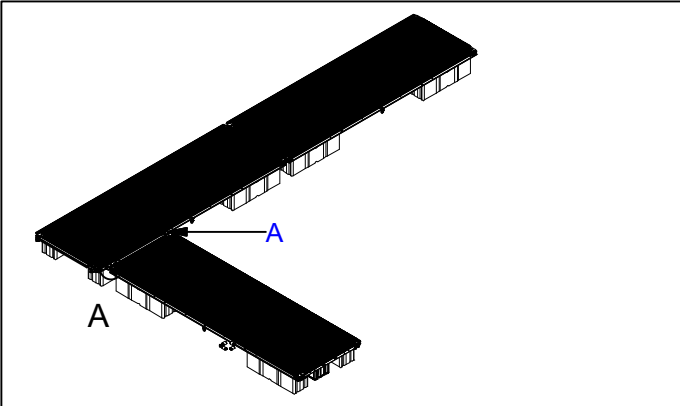

Necessary equipment:

Prestressing factor:
M16 = 210 Nm
M20 = 412 Nm

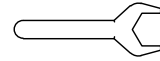

Spanner for M16 and M20

NB!

- Do not tighten until deformation of any steel or plastic parts.
- Do not put the steel construction directly at the ground to prevent damage at the surface.

PARTS

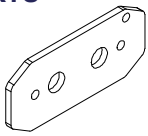

Item 1 x 1
Bracket

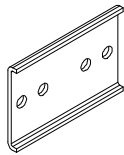

Item 2 x 1
Bracket

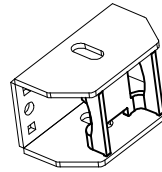

Item 3 x 1
Bracket

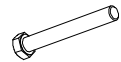

Item 4 x 1
M20 x 150 - DIN 960 VZ



Item 5 x 1
M20 - DIN 985 A4



Item 6 x 2
M20 - DIN 125 VZ



Item 7 x 2
M16 x 40 - DIN 933 VZ



Item 8 x 2
M16 - DIN 125 VZ

A

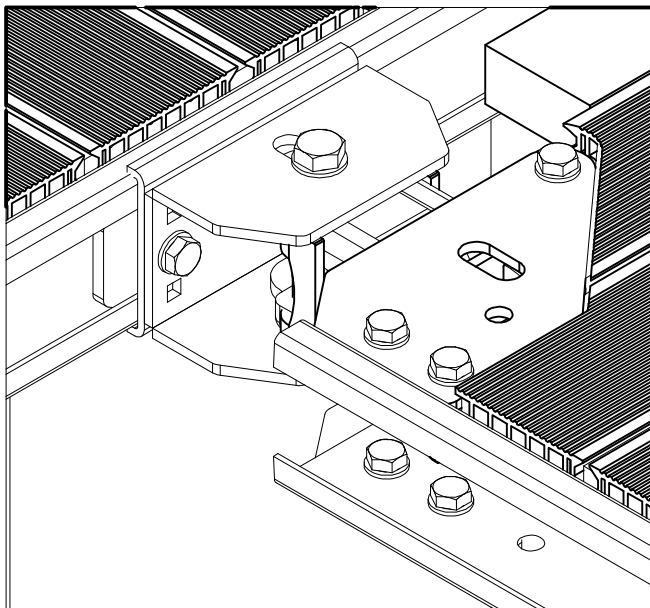

A exploded

